

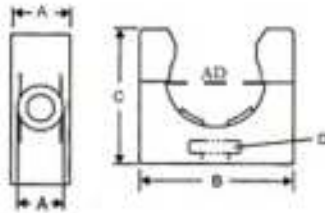

ROHS PAHS



Material: PA6

Temperature Range: Min-40°C, Max105°C

Apply to fixed hoses

Tubing Clamp

Article No. (B) , (G)	Fits to tubing size	A mm	B mm	C mm	E mm	Fastening mm	Packet units
SSH- AD10.0(B.G)	AD10.0	30	23	12.5	M4	7.5	50
SSH- AD13.0(B.G)	AD13.0	30	23	12.5	M5	9	50
SSH- AD15.8(B.G)	AD15.8	30	23	12.5	M5	9	50
SSH- AD18.5(B.G)	AD18.5	35	30	15	M5	9	50
SSH- AD21.2(B.G)	AD21.2	35	30	15	M6	11.5	50
SSH- AD28.5(B.G)	AD28.5	42	38	16	M6	11.5	20
SSH- AD34.5(B.G)	AD34.5	51	43	16	M6	11.5	20
SSH- AD42.5(B.G)	AD42.5	61	51	16	M6	11.5	10
SSH- AD54.5(B.G)	AD54.5	74	64	19	M6	11.5	5

Quick Y-distributor Connector



Material: PA6

Temperature Range: Min-40°C, Max120°C, Short-term150°C

Protection degree: IP 66

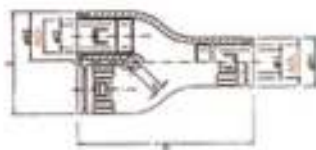

ROHS PAHS

Quick Y-distributor Connector

Article No. (B) , (G)	AD 1 mm	AD 2 mm	B1 mm	B2 mm	D mm	C mm	Φ F mm	Packet units
SSYG- AD10.0/2X10.0(B.G)	10.0	2×10.0	17.0	17.0	50	37	1×4.0	10
SSYG- AD21.2/2X15.8(B.G)	21.2	2×15.8	29.7	23	75	52	1×4.0	10
SSYG- AD28.5/2X15.8(B.G)	28.5	2×15.8	37.5	23	75	52	1×4.0	10
SSYG- AD18.5/2X18.5(B.G)	18.5	2×18.5	26.2	26.2	75	56	1×4.0	10
SSYG- AD21.2/2X21.2(B.G)	21.2	2×21.2	29.7	29.7	76.5	63	1×4.0	10
SSYG- AD28.5/2X21.2(B.G)	28.5	2×21.2	37.4	29.7	76.5	63	1×4.0	10