

# Quick Elbow Connector

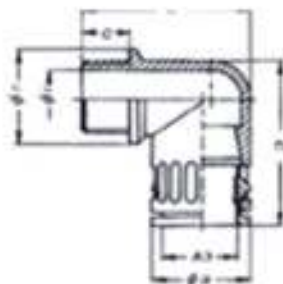

- Material: PA6
- Temperature Range: Min-40°C, Max105°C, Short-term150°C
- Protection degree: IP 66



## SQW-AD/M Quick Elbow Connector

Article No. (B) , (G)	Fits to tubing size	Thread dimension	φI ID mm	φB OD mm	C Thread length	D Total height	E Total length	φF Conne- ction
SQW- AD10.0/M10 (B.G)	AD10.0	M10×1.0	7	17	10	33.5	32	16
SQW- AD13.0/M12 (B.G)	AD13.0	M12×1.5	8	20.2	10	36	34	20
SQW- AD15.8/M16 (B.G)	AD15.8	M16×1.5	12	23.2	10	42	47	23.2
SQW- AD18.5/M18 (B.G)	AD18.5	M18×1.5	14	26.2	11	45	44	27
SQW- AD21.2/M20 (B.G)	AD21.2	M20×1.5	15.5	29.7	13	50	49	29.7
SQW- AD28.5/M25 (B.G)	AD28.5	M25×1.5	18	37.5	13	57	56.2	34.2
SQW- AD34.5/M32 (B.G)	AD34.5	M32×1.5	24	44	12	67.5	63	43
SQW- AD42.5/M40 (B.G)	AD42.5	M40×1.5	32	52	12	83	70	52
SQW- AD54.5/M50 (B.G)	AD54.5	M50×1.5	39	64	14	88	83	64
SQW- AD54.5/M63 (B.G)	AD54.5	M63×1.5	53	64	14	88	83	64

## SQW-AD/P Quick Elbow Connector

Article No. (B) , (G)	Fits to tubing size	Thread dimension	φI ID mm	φB OD mm	C Thread length	D Total height	E Total length	φF Conne- ction
SQW- AD10.0/P7 (B.G)	AD10.0	PG 7	8.5	17	10	33.5	32	16
SQW- AD13.0/P9 (B.G)	AD13.0	PG 9	12	20.2	10	36	34	20
SQW- AD15.8/P11 (B.G)	AD15.8	PG 11	15.5	23.2	10	42	37.0	23.2
SQW- AD18.5/P13.5 (B.G)	AD18.5	PG 13.5	13.5	26.2	11	46	44	27
SQW- AD21.2/P16 (B.G)	AD21.2	PG 16	18	29.7	12	50	49	29.7
SQW- AD28.5/P21 (B.G)	AD28.5	PG 21	24	37.5	12	57	56.2	34.2
SQW- AD34.5/P29 (B.G)	AD34.5	PG 29	32	44	12	67.5	63	43
SQW- AD42.5/P36 (B.G)	AD42.5	PG 36	36.5	52	12	83	70	52
SQW- AD54.5/P48 (B.G)	AD54.5	PG 48	48.5	64	14	88	83	64